

MARVEL

IRON MAN 3

MARK 42 LIFE-SIZE FIGURE

CONTENTS

Your Iron Man Mark XLII is assembled in SIX (6) major sections:



1.) BASE



2.) LEGS / LOWER BODY



3.) TORSO



4.) LEFT ARM | 5.) RIGHT ARM



6.) HEAD

Also included are the following parts

HARDWARE:

Long Metal Rods - TWO (2)

Metal Wing Nuts - TWO (2)

Metal Nuts - TWO (2)

Metal Washers - FOUR (4)

MISC:

Power Plug

Touch Up Paint (FOUR Colors - Red, Gold, Silver, Black)



WHAT YOU WILL NEED

Assembly requires a minimum of TWO people
Assembly requires basic tool(s)
•Phillips Head Screwdriver

ASSEMBLY



STEP 1

Unpack BASE. Remove bottom panel using screwdriver and locate power wire/plug.



STEP 2

a.

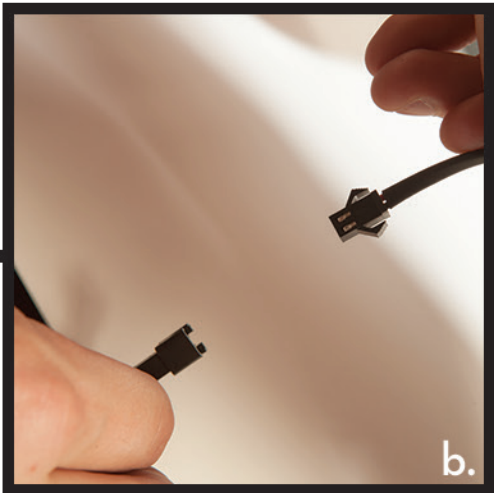

b.

Unpack LEGS/LOWER BODY. Check that power wire is fed through from opening at waist to opening at bottom of left foot. (a.) Check connection points at bottom of left foot and inside base. (b)

STEP 3



Attach Long Metal Rods to the bottom of each foot.

STEP 4

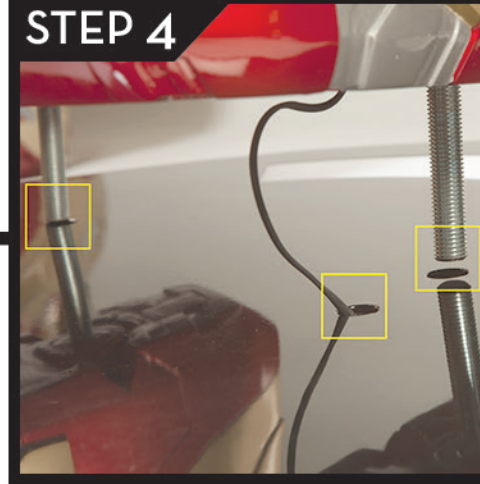

Place LEGS/LOWER BODY onto BASE, positioning rods into holes on the BASE. Take care to feed the wire from LEFT LEG into the base as well.

STEP 5



Use Metal Washers and Wing Nuts to fasten the Metal Rods inside the BASE.

STEP 6



Replace bottom panel to close base section.

STEP 7

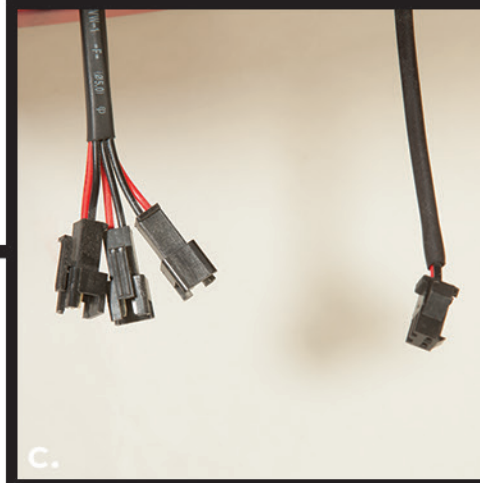
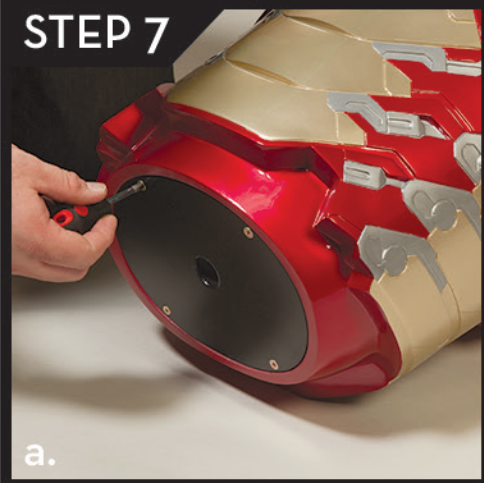

Unpack TORSO, remove bottom panel (a). Locate wires (b). There will be a group of THREE connections [For LEFT ARM, RIGHT ARM and HEAD], and another SINGLE connection to plug into LOWER BODY (c).

STEP 8

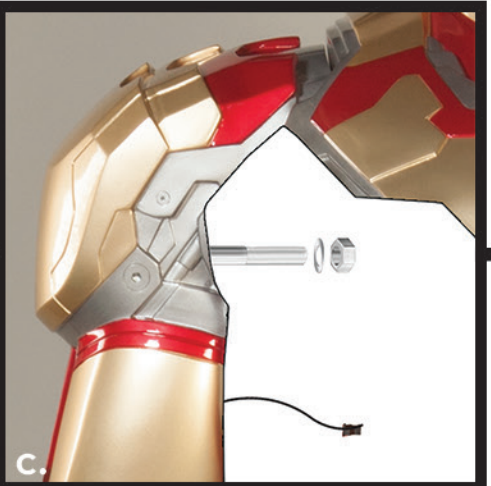
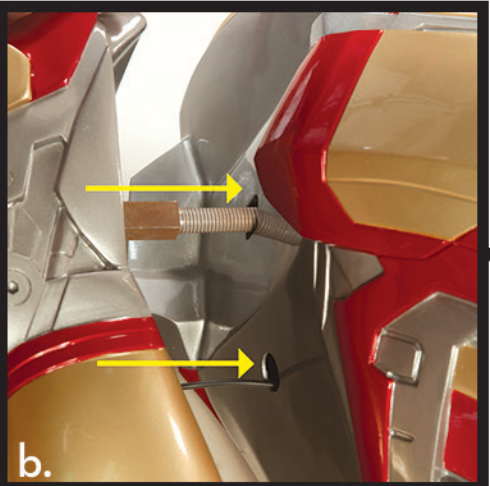
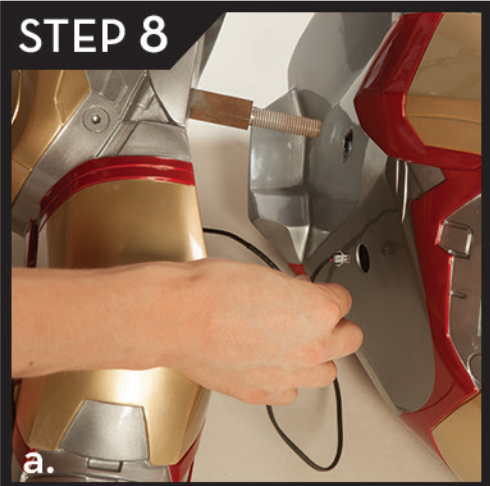

Unpack LEFT ARM and RIGHT ARM. Attach LEFT ARM by sliding the peg into the TORSO, take care to feed the LEFT ARM wire in through the same opening. (a & b) Attach LEFT ARM with Metal Washer and Metal Nut (carefully tighten with small wrench if desired. (c)

REPEAT STEPS FOR RIGHT ARM.

STEP 9



Connect LEFT ARM and RIGHT ARM WIRES to the wires inside TORSO.

STEP 10



Unpack HEAD. Locate wire. Position HEAD onto TORSO, taking care to feed the wire from the head into the opening at the top of the TORSO. Firmly Push HEAD down to fit snugly onto TORSO.

STEP 11



Connect HEAD wire to the wire inside TORSO.

STEP 12



Replace bottom panel on TORSO, taking care to feed the main connection wire out the opening in the bottom panel.

STEP 13

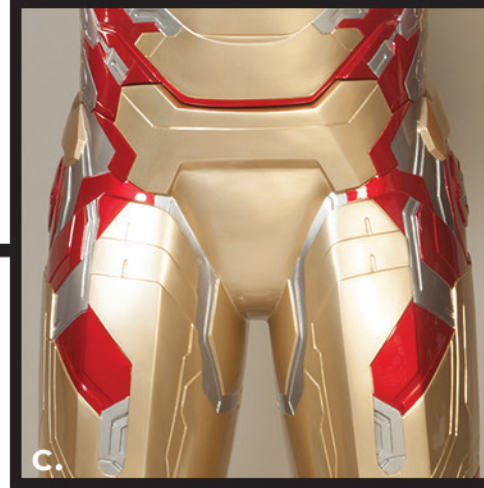

Connect TORSO wire to LOWER BODY wire (a) and feed the excess cord down into the LOWER BODY (b). Position TORSO over peg on LOWER BODY, lower the TORSO onto the LOWER BODY (c).

STEP 14



Connect Power Cord to back of base. Plug into Wall Outlet for Light Up Feature. .



DISTRIBUTION BY:
SIDESHOW
COLLECTIBLES



© MARVEL